

**GENERAL NOTES:**

IN MULTI STOREY PROJECTS THE SERVICE DUCT DIMENSION MAY NEED TO INCREASE TO ACCOMMODATE LARGER PIPE DIMENSIONS. DUCT DIMENSIONS SHOULD BE DETERMINED AND AGREED WITH EMPLOYERS/ TENANTS AGENT.

ALL DIMENSIONS ARE CLEAR DIMENSIONS (WALL TO WALL FINISH) DIMENSIONS SHOWN ARE FOR TYPICAL TIMBER FRAME OR METSEC CONSTRUCTIONS.

CONTRACTOR TO ALLOW FOR SILICONE MASTIC SEALANT TO FURNITURE/WALL JUNCTIONS ONLY. MAPEI, MAPESIL AC REF: 111 SILVER GREY.

CONTRACTOR TO ALLOW FOR APPLYING SEALANT AT THE FOLLOWING JUNCTIONS SUBJECT TO INSPECTION AND CONFIRMATION BY EMPLOYERS/TENANT'S AGENT:

DRESSING TABLE/PARTITION

**DRAWING NOTES:**

- 1.01 BEDSIDE SHELF INCORPORATED WITHIN HEADBOARD.
- 1.02 BEDHEAD, LIT FROM WITHIN WITH FLUORESCENT LIGHT FITTINGS.
- 1.03 BED.
- 1.04 TOWEL RAIL.
- 1.05 GRAB RAIL.
- 1.06 SHOWER CURTAIN AND RAIL.

- 1.07 BATH.
- 1.08 SHOWER HEAD.
- 1.09 FIRE PROTECTED SERVICE DUCT (SUBJECT TO LOCAL AUTHORITY APPROVAL).
- 1.10 WASH HAND BASIN.
- 1.11 W.C.
- 1.12 TOILET ROLL HOLDER.
- 1.13 ADDITIONAL HANDRAIL TO AMBULANT BATHROOM ONLY.

- 1.14 HANGING STORAGE UNIT.
- 1.15 MIRROR.
- 1.16 ELECTRIC PANEL HEATER
- 1.17 WALL MOUNTED VENEERED PANEL WITH PRE-FITTED TELEVISION BRACKET.
- 1.18 MIRROR WITH INTEGRAL WALL LIGHT ABOVE.
- 1.19 'GUBBIO' CHAIR.
- 1.20 VENEERED DESK.

- 1.21 ROLLER BLIND.
- 1.22 SHEER CURTAIN (SITE SPECIFIC).
- 1.23 WINDOWS FITTED WITH JACKLOC RESTRICTOR AS M14.
- 1.24 SOFABED.
- 1.25 PICTURE
- 1.26 FLOOR MOUNTED DOOR STOP



CONTENTS: STANDARD, FAMILY AND AMBULANT ROOM - SETTING OUT AND FIXTURES

FEBRUARY 2007

BD - 001 REV B

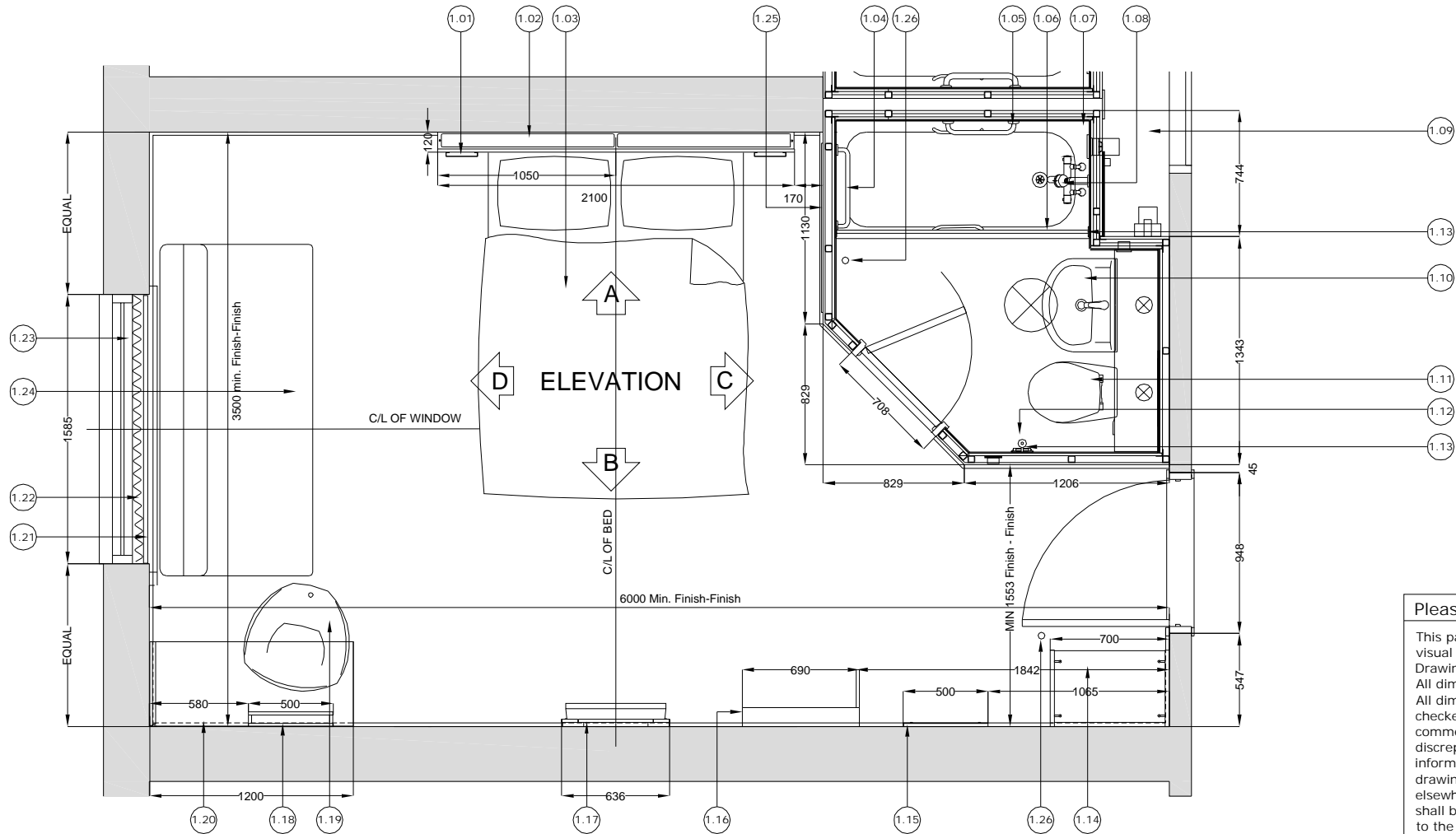

**Please Note:**  
 This page is intended for visual reference only. Drawings are not to scale. All dimensions are in mm. All dimensions are to be checked on site prior to commencing work. Any discrepancy found between information given on this drawing and that given elsewhere or recorded on site shall be notified immediately to the Employers/Tenants agent in writing.